

SMART
MACHINE TOOL

SV3

**Installation
Packet**

SV-3 Floor Space Diagram with chip conveyor For reference only

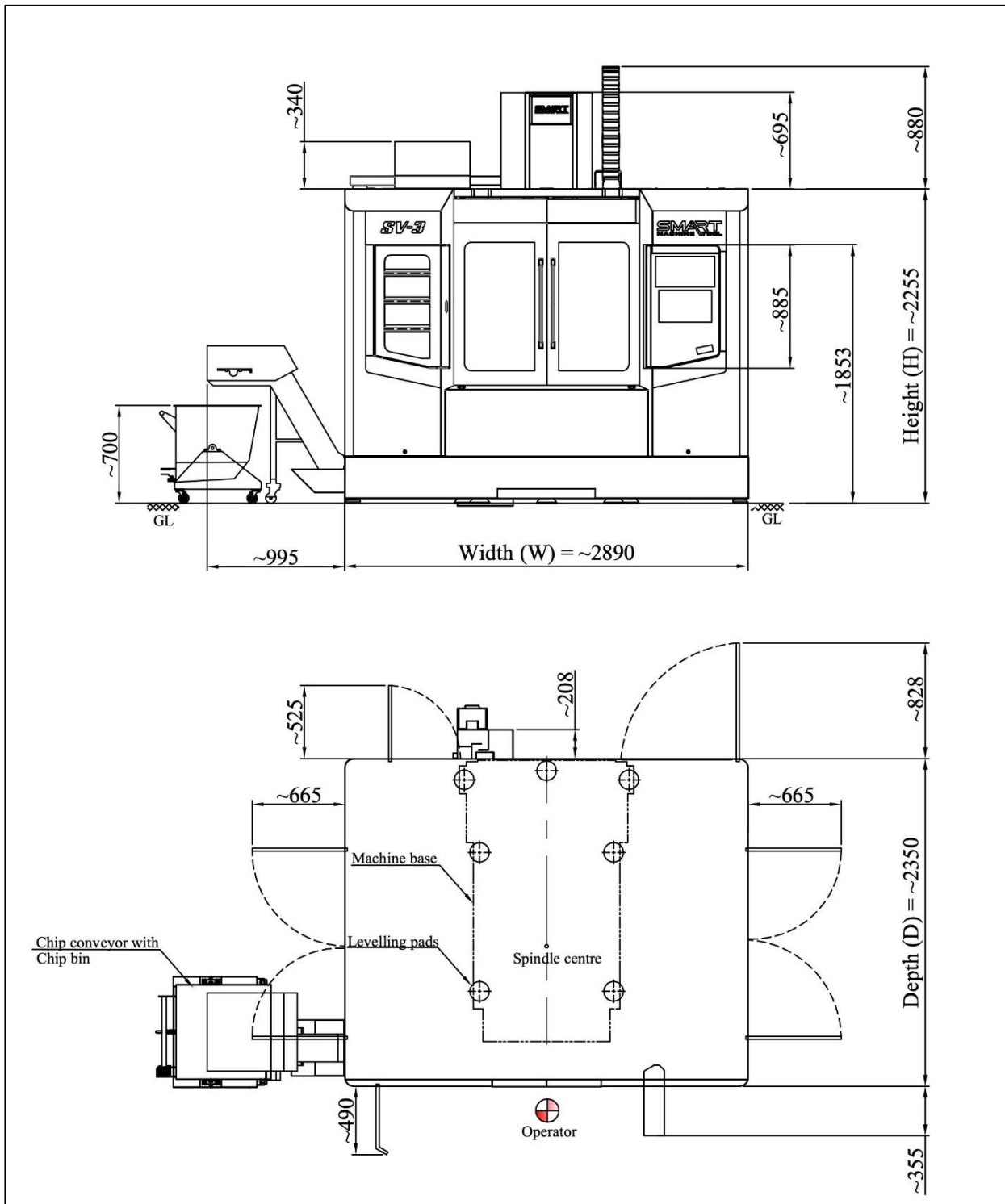

2.10 Installation instructions for the machine



WARNING

- Only qualified personnel are authorised to carry out power connections.
- In order to prevent anyone from turning Power on by mistake during power connection, place a tag or placard reading “Never turn Power On” at a prominent place.

1. Connect the mains cable to R, Y, B and PE.

Input Voltage	220V, 3 Phase AC
Maximum voltage fluctuation	± 5%
Maximum line to line fluctuation	5%
Frequency	60Hz
Type of Earthing	Type C / D Chemical Earthing
Voltage Stabilizer	Required. Refer the below table for capacity
Isolation Switch for Stabilizer	100 A as per capacity

Machine Model	Power Capacity	Cable Size	Rating of Isolation Switch	AMPS AT 220V
SV-2	25 KVA	16 mm ²	100 A	65.5
SV-3	25 KVA	16 mm ²	100 A	65.5
SV-5	35 KVA	16 mm ²	100 A	92

2. Connect ground terminal to PE.
3. Coolant Motor, Flush Coolant Motor, Coolant through tool motor arrange as per drawing of coolant tank & make electrical connection for the same.
4. Perform checking as follows:
 - Check for proper earth connections and 3-phase input supply connection.
 - Check for the 3-phase input supply.
 - Put on the Main Switch.
 - Press NC ON push button.  The display appears.
 - Release all Emergency Stops (on the machine operator panel and chip conveyor panel if available).
 - Now the machine is ready for operation.

2.7 Removal of axis lock plates



CAUTION

- Remove the axis lock plates from the slides before turning the power On.
- Upon delivery, the axis lock plates are used for transportation. Ensure that they are removed before operating the machine. These lock plates can be retained and reused whenever the machine is moved again.

2.8 Lifting diagram

While lifting the machine, refer details as given below:-

Model	Unit	SV-2	SV-3	SV-5
Net Weight	Kg	4800	6100	8500

CAT 40 Pull Stud and Tool holder

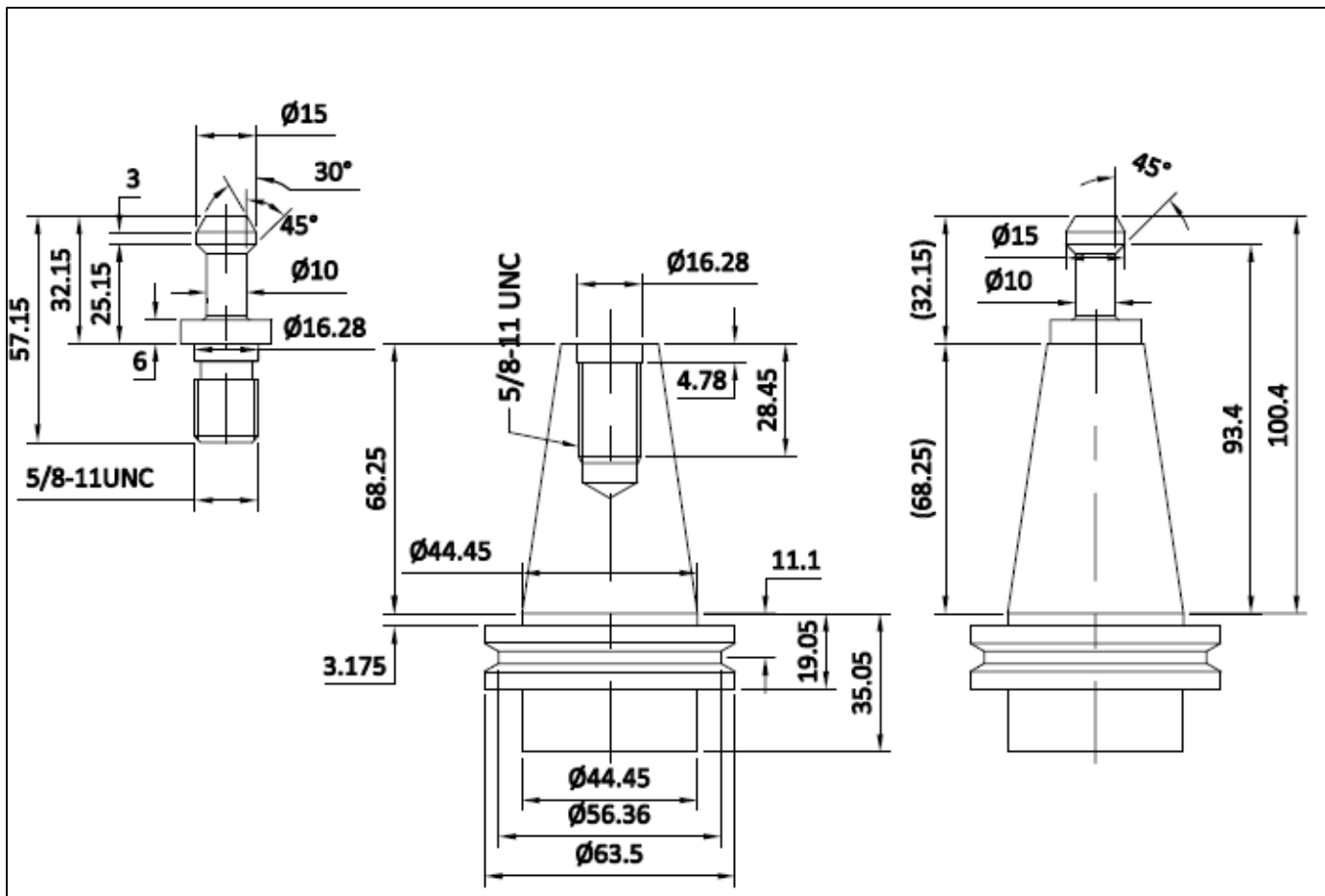

Power-Torque Diagram

40