

SMART
MACHINE TOOL

SV2

**Installation
Packet**

SV-2 Floor Space Diagram with chip conveyor For reference only

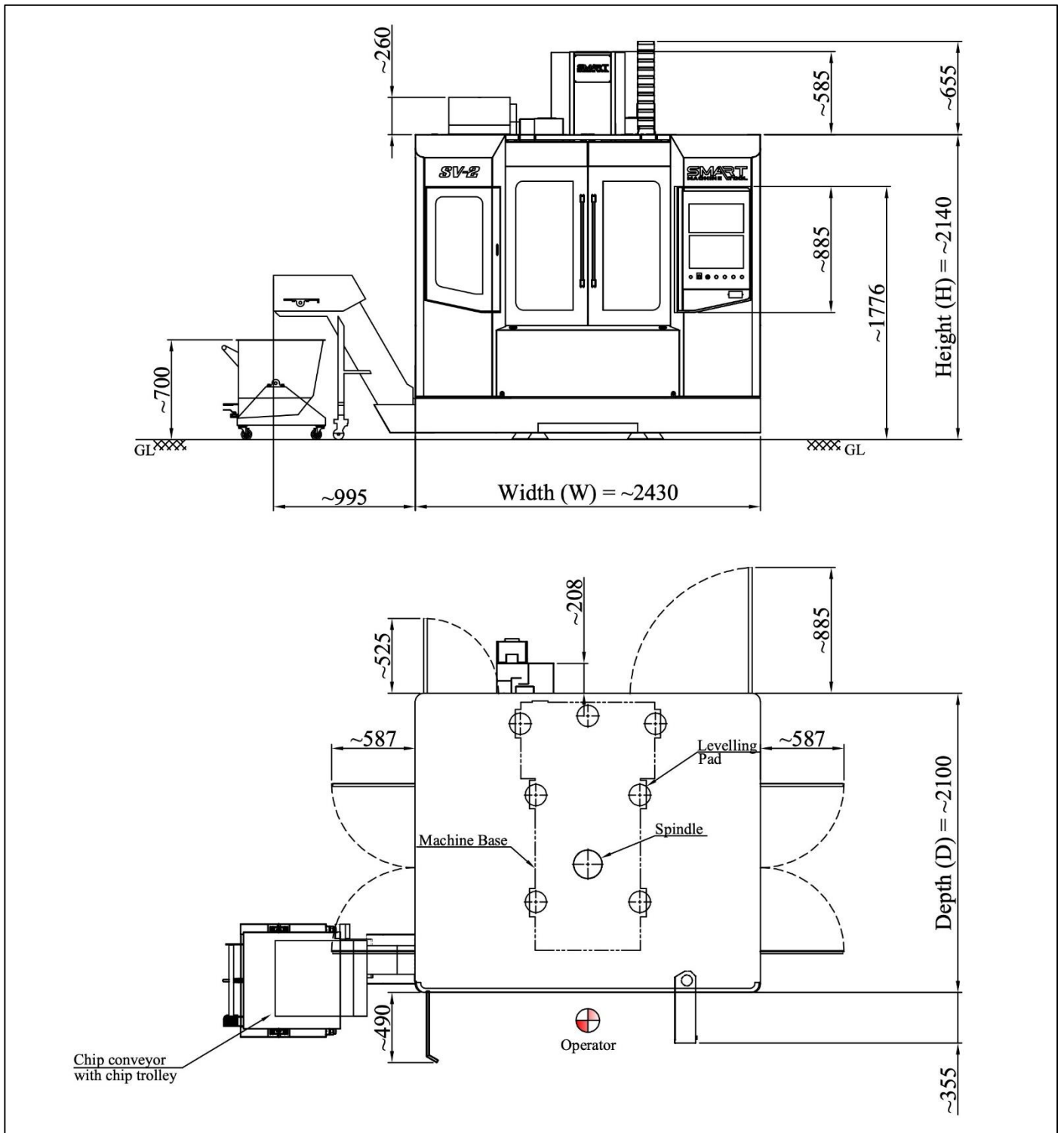

2.10 Installation instructions for the machine



WARNING

- Only qualified personnel are authorised to carry out power connections.
- In order to prevent anyone from turning Power on by mistake during power connection, place a tag or placard reading “Never turn Power On” at a prominent place.

1. Connect the mains cable to R, Y, B and PE.

| | |
|---|--|
| Input Voltage | 220V, 3 Phase AC |
| Maximum voltage fluctuation | ± 5% |
| Maximum line to line fluctuation | 5% |
| Frequency | 60Hz |
| Type of Earthing | Type C / D Chemical Earthing |
| Voltage Stabilizer | Required. Refer the below table for capacity |
| Isolation Switch for Stabilizer | 100 A as per capacity |

| Machine Model | Power Capacity | Cable Size | Rating of Isolation Switch | AMPS AT 220V |
|---------------|----------------|--------------------|----------------------------|--------------|
| SV-2 | 25 KVA | 16 mm ² | 100 A | 65.5 |
| SV-3 | 25 KVA | 16 mm ² | 100 A | 65.5 |
| SV-5 | 35 KVA | 16 mm ² | 100 A | 92 |

2. Connect ground terminal to PE.
3. Coolant Motor, Flush Coolant Motor, Coolant through tool motor arrange as per drawing of coolant tank & make electrical connection for the same.
4. Perform checking as follows:
 - Check for proper earth connections and 3-phase input supply connection.
 - Check for the 3-phase input supply.
 - Put on the Main Switch.
 - Press NC ON push button.  The display appears.
 - Release all Emergency Stops (on the machine operator panel and chip conveyor panel if available).
 - Now the machine is ready for operation.

2.7 Removal of axis lock plates



CAUTION

- Remove the axis lock plates from the slides before turning the power On.
- Upon delivery, the axis lock plates are used for transportation. Ensure that they are removed before operating the machine. These lock plates can be retained and reused whenever the machine is moved again.

2.8 Lifting diagram

While lifting the machine, refer details as given below:-

| Model | Unit | SV-2 | SV-3 | SV-5 |
|------------|------|------|------|------|
| Net Weight | Kg | 4800 | 6100 | 8500 |

CAT 40 Pull Stud and Tool holder

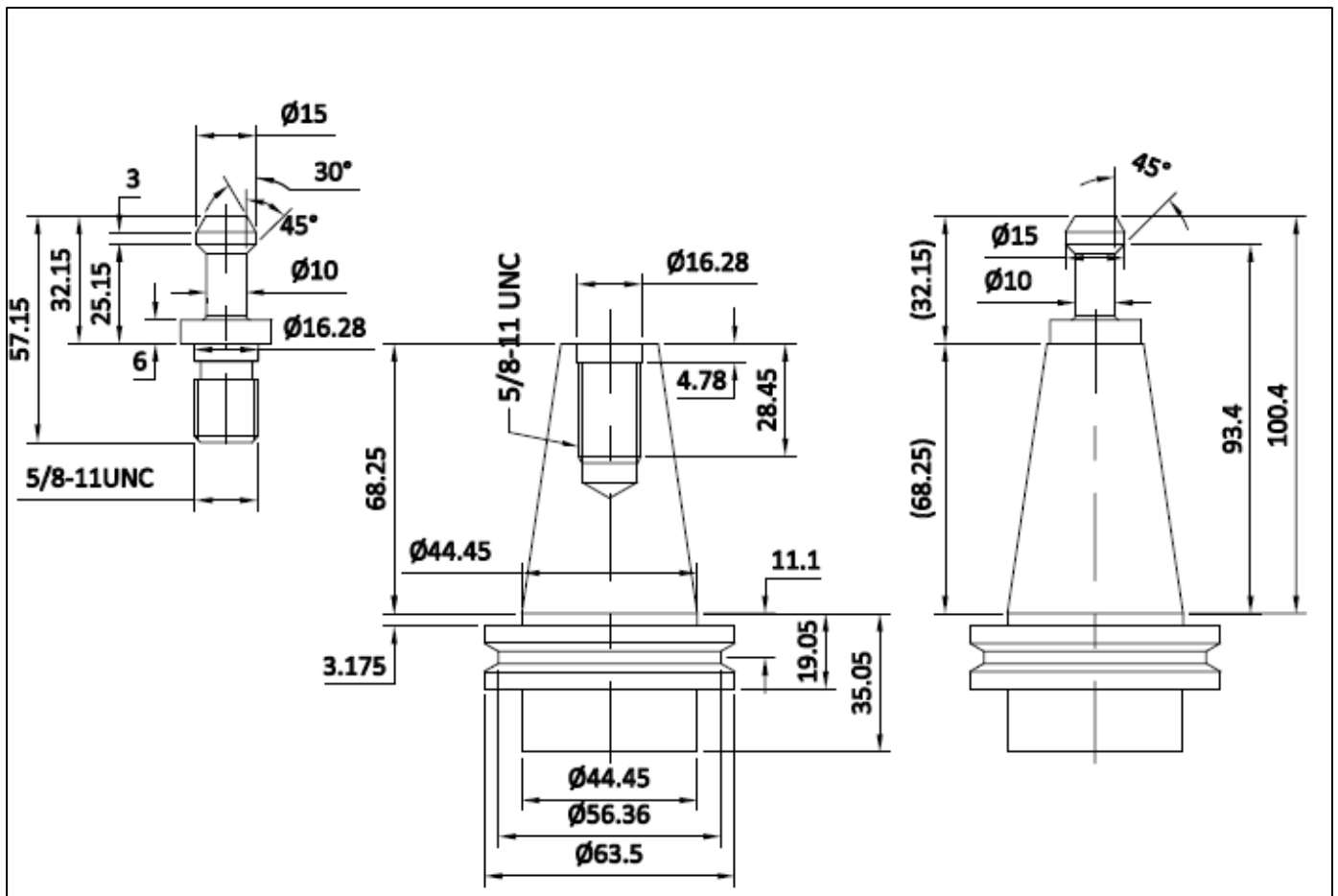

Power-Torque Diagram