

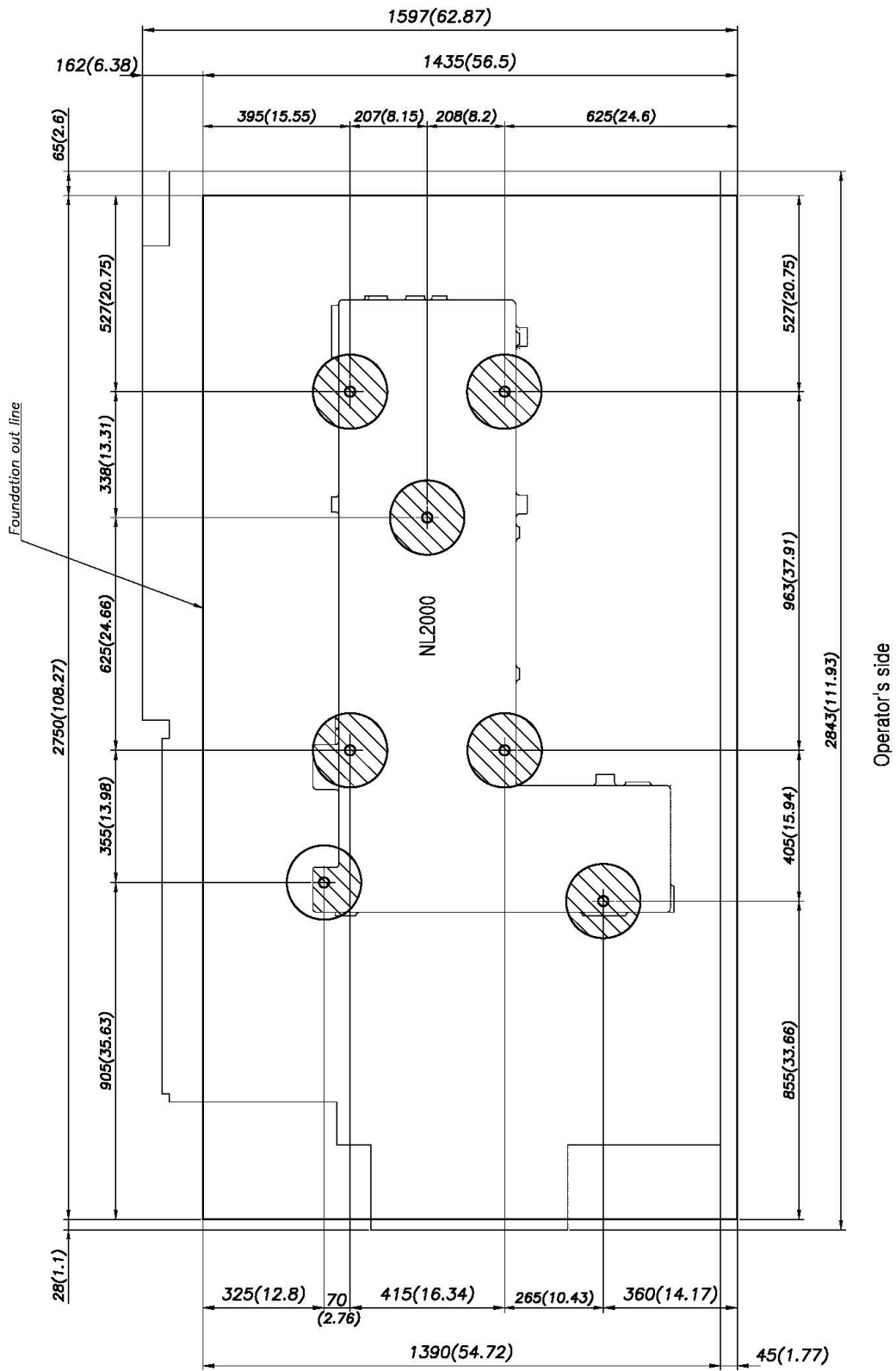

NL 2000
(M)(B)
Installation
Packet

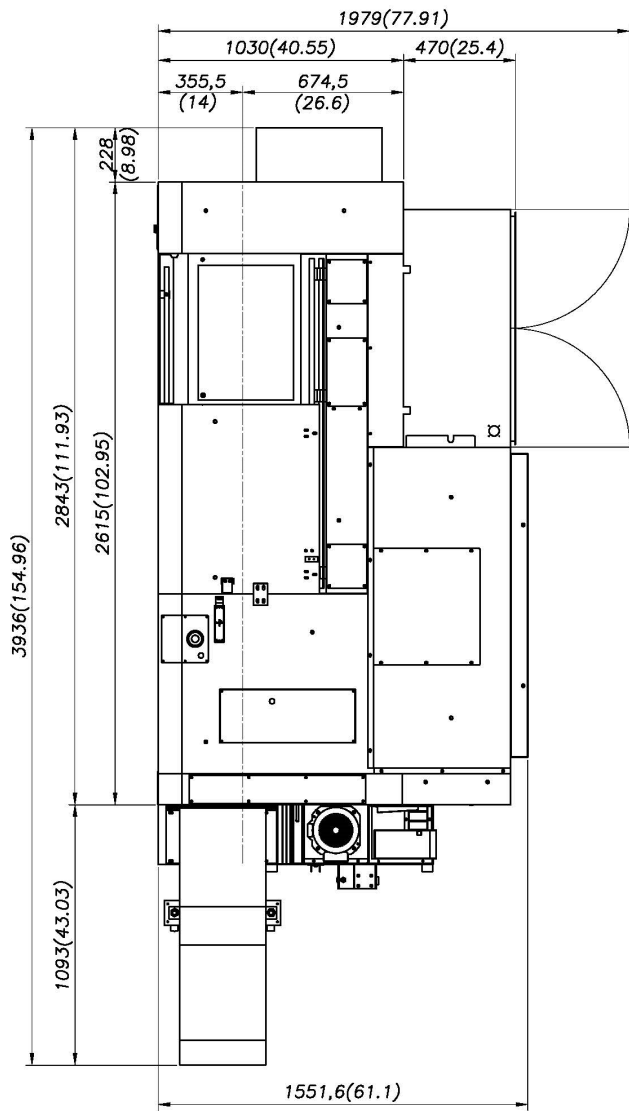



() : inch

MACHINE MODEL	KVA	AMPS @ 220	Coolant	Slideways	Hyd. Unit	Transmission	Chuck	Oil for Air
NL2000(M)	31	82	48	.79 gal	5.3 gal	n/a	.2 oz daily	.6 oz
NL2500(M)	40	105	53	.79 gal	5.3 gal	0.75	.2 oz daily	.6 oz
NL3000(M)	40	105	63	.79 gal	5.3 gal	0.75	.2 oz daily	N/A
NL4000(M)	55	144	63	.79 gal	6.4 gal	0.75	.2 oz daily	N/A
NL5000(M)	55	144	63	.79 gal	6.4 gal	0.75	.2 oz daily	N/A
NL5000L(M)	65	170	130	.79 gal	6.4 gal	0.75	.2 oz daily	N/A
NL6000(M)	65	170	105	.79 gal	15 gal	0.75	.2 oz daily	N/A
NL6000L(M)	65	170	150	.79 gal	15 gal	0.75	.2 oz daily	N/A
NL6000XL(M)	65	170	180	.79 gal	15 gal	0.75	.2 oz daily	
NL7000L(M)	65	170	150	.79 gal	15 gal	2 gal	.2 oz daily	N/A
NL7000XL(M)	65	170	180	.79 gal	15 gal	2 gal	.2 oz daily	N/A
				Shell Oil T68	Mobil DTE	Mobil Oil Light		DTE Light
				Mobil Vactra#	24	ISO VG 32	grease daily	check daily
				check daily	check daily	check daily		

Conestoga Trailers arranged by Walsh Logistics required for all machine shipments

Model	Description	ESTIMATED PACKING	
		(Size - FEET)	(Size - LBS)
NL2000(M)(B)	MACHINE	13x7.5x7.5	10,500
NL2500(M)	MACHINE	14.5x7.5x7	13,900
NL2500(M)	CHIP CONVEYOR	12.5x3x5	850
NL3000(M)	MACHINE	15.5x7.5x7	16,500
NL3000(M)	CHIP CONVEYOR	12.5x3x5	870
NL4000(M)	MACHINE	16x7.5x8	25,000
NL4000(M)	CHIP CONVEYOR	14x3.1x5	1,925
NL5000(M)	MACHINE	16x7.5x8	25,500
NL5000(M)	CHIP CONVEYOR	14x3.1x5	1,925
NL5000L(M)	MACHINE	20x7.5x8	32,000
NL5000L(M)	CHIP CONVEYOR	18x3.1x5	2,500
NL6000(M)	MACHINE	18.7x7.5x8.4	35,250
NL6000(M)	CHIP CONVEYOR	15.9x7.5x5.75	2,350
NL6000L(M)	MACHINE	21x7.5x8.5	40,000
NL6000L(M)	CHIP CONVEYOR	18.2x7.5x5.75	4,000
NL6000XL(M)	MACHINE	26x7.5x8.5	50,000
NL6000XL(M)	CHIP CONVEYOR	22.5x7.5x5.75	5,500
NL7000L(M)	MACHINE		
NL7000XL(M)	MACHINE		